



New Freud Sanitary Station
03/19/24

Agenda

- ◆ Project Goals & Design
- ◆ Project Advantages
- ◆ Project Renderings
 - ◆ Overhead View
 - ◆ Northwest Street View
 - ◆ Northeast Street View
- ◆ Project Schedule
- ◆ Traffic Control
- ◆ Questions



Project Goals & Design

- 💧 Protect the Health, Safety, & Welfare of Residents
- 💧 Improve the Reliability of Freud Storm Pump Station
 - 💧 Rehabilitation
 - 💧 Isolation
 - 💧 Cleaning
 - 💧 Inspection
 - 💧 Maintenance
- 💧 Utilize one Sanitary Pump Station for both Ashland & Fox Creek Sewers
- 💧 Improve Sanitary Flow
- 💧 Design for City Master Plan



Project Advantages

- ◆ Improved Reliability of Storm & Sanitary Systems
- ◆ Traffic Calming
- ◆ Enhanced Landscaping Plan
- ◆ Bioswales & Rain Gardens
- ◆ Doubling of Mature Trees
- ◆ Abandoned Structure Removal
- ◆ Improved Drainage at Freud Storm Pump Station

Rendering - Overview

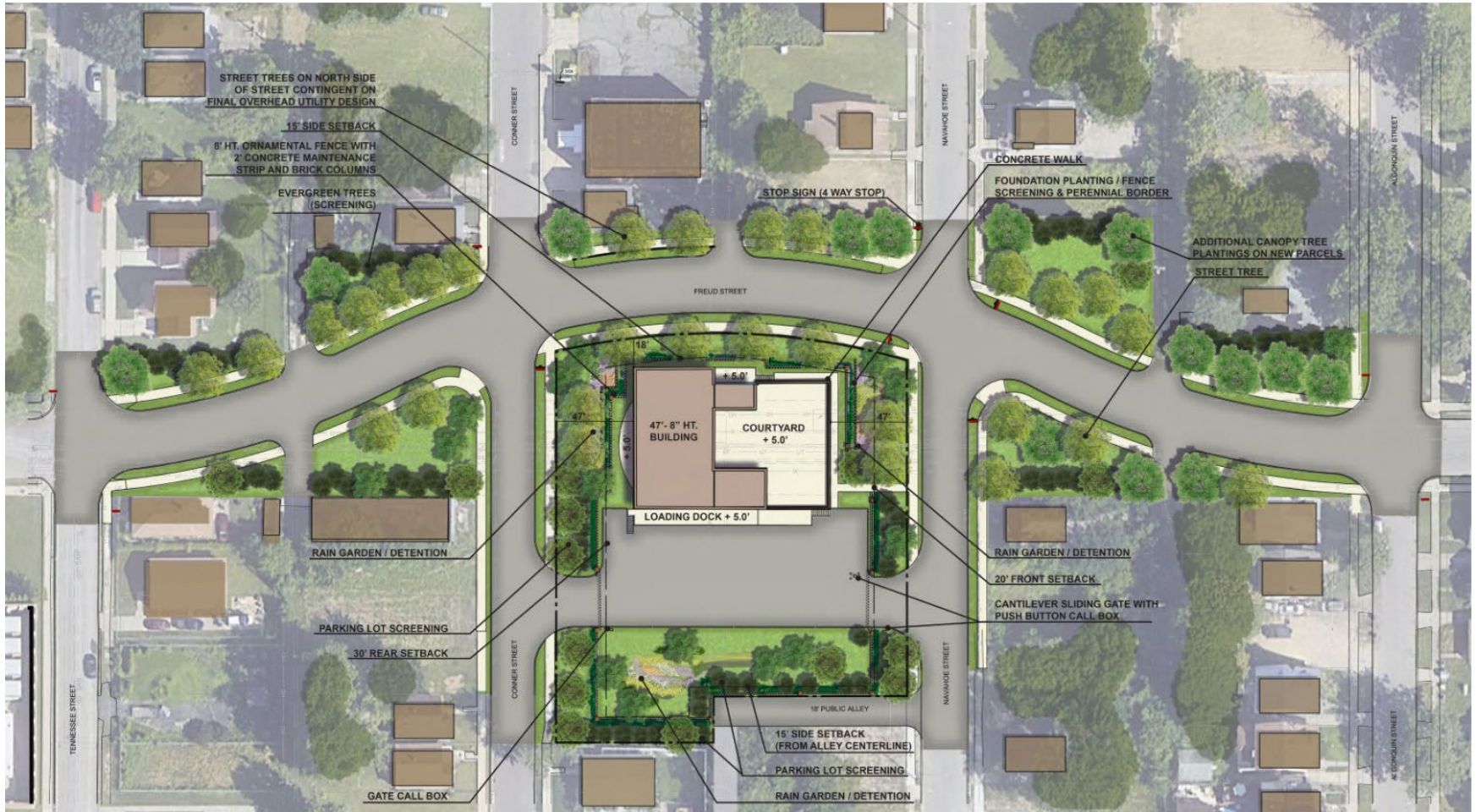

Rendering – Northwest Street View



Rendering – Northeast Street View



Traffic Control

- Freud Street Road Closure
- Traffic will be routed along:
 - Essex Ave
 - East Jefferson Ave

Traffic Flow →
Road Closure 
Through Traffic Closure 



Project Schedule

◆ Contractor Notice to Proceed	Q2 2024
◆ Abandoned Structure Removal	Q2 2024
◆ Contractor Site Mobilization	Q4 2024
◆ Project Completion	Q2 2028

*Project Schedule is in development more details to follow.

Questions

